

Trails Village

1910-1930 Village Center Circle
Las Vegas, NV 89134

PROPERTY DETAILS

- | 1910 Suite 1, Size: 2,525 SF
- | Cams: \$0.65 psf
- | Fully Built Out Restaurant
- | Do Not Disturb existing Tenant



CORNERSTONE

COMMERCIAL REAL ESTATE SERVICES

Richard W. Truesdell
President/Broker
Lic.# B.0001174

Justin Michaels
Vice President
Lic.# S.0068221

820 Rancho Lane, Suite 85, Las Vegas, NV 89106
P: 702-383-3033 | F: 702-383-8576
www.cornerstonecre.com

Disclaimer: The information above has been obtained from sources believed reliable. While we do not doubt its accuracy, we have not verified it and make no guarantee, warranty or representation about it. It is your responsibility to independently confirm its accuracy and completeness. Any projections, opinions, assumptions or estimates used are for example only and do not represent the current or future performance of the property. The value of this transaction to you depends on tax and other factors which should be evaluated by your tax, financial and legal advisors. You and your advisors should conduct a careful, independent investigation of the property to determine for your satisfaction the suitability of the property for your needs. This information has been prepared exclusively for the clients of Cornerstone Company and is confidential. It is the property of Cornerstone Company, and reproduction of any portion without the written consent of Cornerstone Company is strictly prohibited.

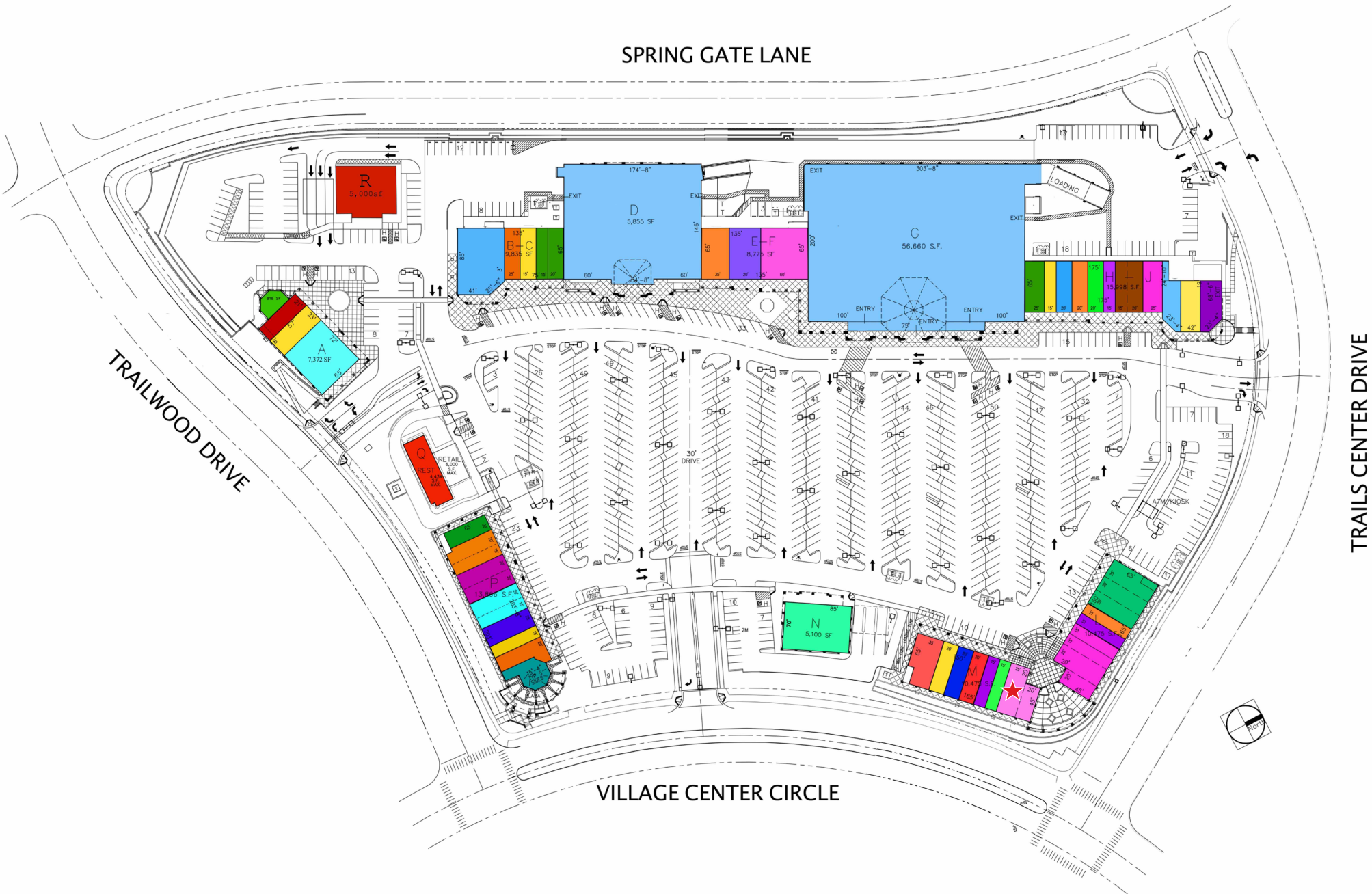

SPRING GATE LANE

TRAILWOOD DRIVE

VILLAGE CENTER CIRCLE

TRAILS CENTER DRIVE

Disclaimer: The information above has been obtained from sources believed reliable. While we do not doubt its accuracy, we have not verified it and make no guarantee, warranty or representation about it. It is your responsibility to independently confirm its accuracy and completeness. Any projections, opinions, assumptions or estimates used are for example only and do not represent the current or future performance of the property. The value of this transaction to you depends on tax and other factors which should be evaluated by your tax, financial and legal advisors. You and your advisors should conduct a careful, independent investigation of the property to determine for your satisfaction the suitability of the property for your needs. This information has been prepared exclusively for the clients of Cornerstone Company and is confidential. It is the property of Cornerstone Company, and reproduction of any portion without the written consent of Cornerstone Company is strictly prohibited.

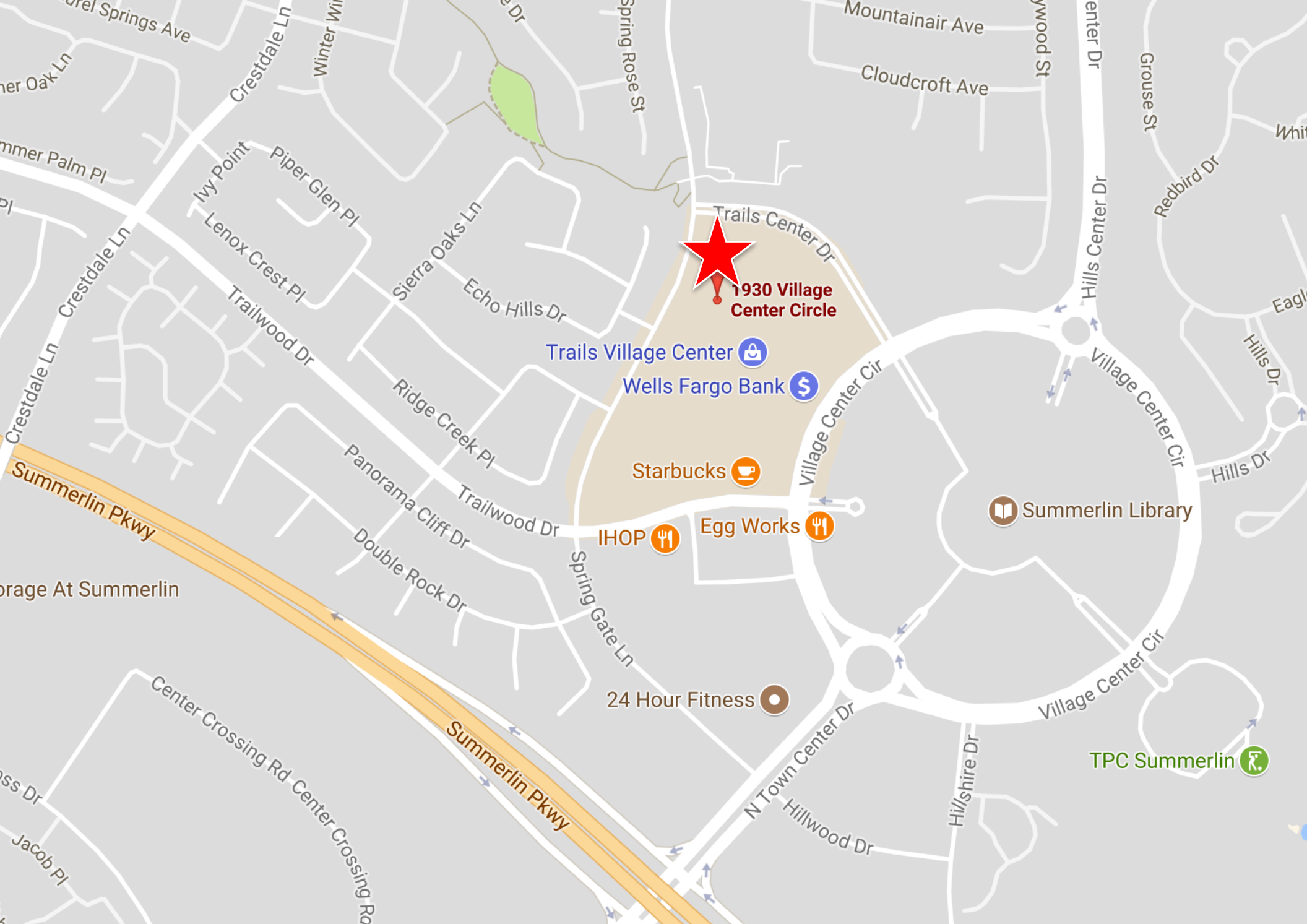

Disclaimer: The information above has been obtained from sources believed reliable. While we do not doubt its accuracy, we have not verified it and make no guarantee, warranty or representation about it. It is your responsibility to independently confirm its accuracy and completeness. Any projections, opinions, assumptions or estimates used are for example only and do not represent the current or future performance of the property. The value of this transaction to you depends on tax and other factors which should be evaluated by your tax, financial and legal advisors. You and your advisors should conduct a careful, independent investigation of the property to determine for your satisfaction the suitability of the property for your needs. This information has been prepared exclusively for the clients of Cornerstone Company and is confidential. It is the property of Cornerstone Company, and reproduction of any portion without the written consent of Cornerstone Company is strictly prohibited.